



## Overview

The E10P is an advanced, compact two-way active loudspeaker designed for a wide variety of pro-audio applications. Innovative processing is built-in to ensure optimum performance and clarity.

Built for maximum versatility, the E10P input section will easily handle microphone or line level inputs through the XLR / TRS Combi-jack. Bass and Treble EQ in addition to Level control and a Mic/Line input gain selector ensure the E10P can handle virtually any audio source. A Live/Playback EQ preset selector, a 100Hz/50Hz low-frequency Roll-off selector (no crossover needed for subs), a full-time Limiter with LED indicator, a Clip LED, a Link output ensure the E10P can adapt easily to any audio application including use as a front-of-house PA loudspeaker, as a personal wedge monitor or as a single unit micro PA for a paging and playback system (no additional mixer required).

A lightweight, low-noise 300-Watt Class-D amplifier drives the low frequency 10-inch woofer while a two-tier 50-Watt amplifier capable of delivering an exceptionally clear and linear high-frequency response powers the 1-inch horn. An on-board active DSP based crossover ensures that the woofer and horn operate optimally while protecting the high quality speaker components.

The E10P features a powerful yet lightweight 10-inch low-frequency driver with a neodymium magnet, a silky-smooth 1-inch horn and driver and an enclosure built from voidless 15mm multi-ply Baltic birch for light weight with classic Elite ruggedness. That durability is engineered into the multi-angle enclosure pioneered for the Elite line that enables the E10P to operate vertically on a stand or horizontally as a stage monitor. For added convenience, the E10P easily converts between 120VAC, 230VAC or 240VAC.



## Features

- Integrated 650 Watt Amplifier (Peak - 325 Watts Program)
- 10-inch Woofer / 1-inch Compression Driver
- Max SPL 129dB Peak (123dB Continuous)
- Bi-Amplified Power Module
- Designed for Front-of-House or Monitor Applications
- 100° x 25° Horn with Peak and Average Horn Protection
- Two Band EQ with LF Roll-Off and Live/Playback Mode Switches
- Combi-Jack XLR and 1/4-inch Input
- Integrated All Metal Speaker Standmount Adaptor
- Solid 5/8-inch (15mm) Birch Plywood Construction
- Made in Canada

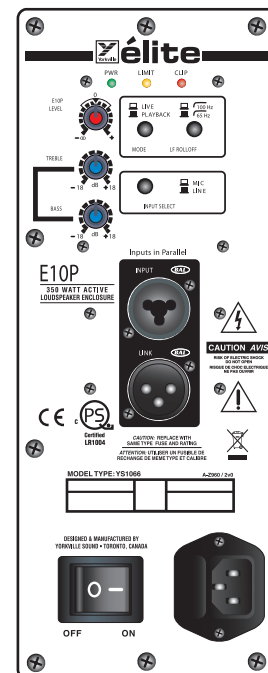

E10P Rear Panel



## Specifications

System Type	Powered Loudspeaker
Active or Passive	Active
Program Power (Watts)	325 Watts (650 Watts Peak)
Max SPL (dB)	129dB Peak (123dB Continuous)
Frequency Response (Hz +/- 3dB)	65 - 20k
Crossover Frequency (Hz)	1500
Driver Configuration	10-inch / 1-inch
HF Dispersion (°H x °V)	100 x 25
HF Protection	Peak and Average Limiting
LF Protection	Excursion, RMS
Cooling Scheme	Convection
Power Cable	Removable IEC
Power Switch	Yes
Power Consumption (typ/max)	120VA / 200VA
Inputs	1 Combijack (XLR / 1/4-inch)
Input Impedance (Bal/UnBal)	4k ohms / 2k ohms
Input Sensitivity (Vrms Sine)	Line in 1.4 at center, 0.35 at max
Level Controls	Gain
EQ Controls	Bass, Treble
Limiter	Peak and Average limiting on horn and woofer
LED Indicators	Power, Clip
Corners	Metal
Feet	Plastic Glides
Flying Hardware	5 (2 Top, 2 Bottom, 1 Pullback)
Bar Handles	One Side
Pole Mount Adapter (1 3/8"-3.5cm)	Yes
Enclosure Materials	15mm (5/8-inch) 11-ply Russian Birch
Port(s)	Rear
Grille	Perforated Metal
Covering / Finish	Black Ozite (Carpet)
Optional Covering / Finishes	Black Ultrathane Paint (E10PB)
Dimensions (DWH xbackW COM inches)	12 x 13 x 18.5 x 5.5
Dimensions (DWH xbackW COM cm)	30 x 33 x 45 x 14
Weight (lbs/kg)	34 / 15.5

*Specifications subject to change without notice*