



Digital UHF Wireless System Model XDS-PLUS

Users Guide

Includes easy setup instructions for single and multi-system operation



24-bit Digital Conversion

No Comanders

Frequency Diversity (anti-jam) Technology

Extended Operating Range

Reliable, Wired Sound and Performance

Multi-channel Operation

Table of Contents

Introduction	1
About the XDS-PLUS Digital Wireless System	1
System Components	1
Receiver Controls & Front Panel	2
Power Button	2
Channel LEDs	2
Audio LEDs	2
Battery LEDs	2
RF LED	2
Receiver LEDs	2
Mode LED	3
Changing Receiver Operating Mode	3
Receiver Connections	4
Antenna A & B Input Connector (BNC)	4
DC Power Input Jack	4
Instrument Output Jack	4
Antenna Installation	5
How to Connect the Supplied Antenna	5
Transmitter Controls	6
Power Button	6
Channel Select Button	6
LED Display	6
Operating Modes for the Transmitter	6
Changing Transmitter Operating Mode	7
Transmitter Connectors	8
Instrument Input	8
Microphone Input	8
Preparing the Transmitter for Use	9
Battery Installation	9
Battery Life	9
Transmitter Mounting Options	10
Attaching the Beltpack to Clothing	10
Troubleshooting	11
Optimizing Performance	12
RF Interference	12
Increasing Range	12
Multi-channel Operation	12
Warranty Information	13
X2 Warranty Policy	13
RF Exposure Statement	13
SERVICE INFORMATION	14
Specifications	15
Frequency Diversity Technology Description	16

Introduction

Created specifically for performing and recording musicians who demand to be untethered without compromising their sound, the XDS-PLUS 24-bit digital wireless system delivers your tone and performance with the sound and feel of a direct wire connection all with extended range and added protection from outside RF interference.

X2's proprietary digital technology provides superior fidelity while the XDR2 stomp-box receiver houses a micro-processor that selects the digital data stream from among the two internal receivers to eliminate dropouts and interference including DTV and other digital signal sources. You'll enjoy the sound and performance of a direct wire connection free from compander ICs - and the associated 'pumping' and 'breathing' - that squash your tone, as well as other problems associated with analog wireless technology. Operating the system is unlike any wireless you've tried before. Simply connect the transmitter to the source via the 1/8" threaded-collar locking connector and the stomp-box receiver to your amplifier or effects pedals. Then power up making sure the transmitter and receiver are set to the same channel. That's it. You're ready to go! No knobs to adjust and no complicated menus to scroll through mean you're up and running in the time it would take to connect a cable.

About the XDS-PLUS Digital Wireless System

All of this sound and performance is provided to you with an incredible feature set including:

- 24-bit digital converters deliver your exact performance without the use of compressors
- >118 dB dynamic range to capture your most expressive performances
- 2009 Compliant means no FCC or DTV concerns
- Dual-frequency transmission eliminates dropouts, multipathing and interference
- Five user-selectable channels (all five are fully compatible for simultaneous use)
- Full bandwidth frequency response 10 Hz - 20 kHz
- Unbalanced 1/4" TRS outputs
- No menus to scroll through!
- Real-time LEDs display critical performance indicators including: operating channel, RF status, link status, audio level, diversity mode and transmitter battery life

With the XDS-PLUS Digital UHF Wireless System you'll have the freedom and sound to deliver your most expressive performance every time without any hassles or complicated setup procedures.

Thank you for choosing X2!

We have designed this product to give you reliable operation for many years to come. Over 10 years of accumulated expertise in the design and manufacture of high-quality digital wireless systems have made X2 the leading company in this field. To familiarize you with your new digital wireless system, we suggest that you read through this entire operation manual.

System Components

- (1) XDR2 Digital UHF receiver
- (1) XDT4 Digital UHF transmitter
- (2) detachable antenna
- (1) 9 V Alkaline Battery
- (1) 1/4" to 1/8" locking connector instrument cable
- (1) 9V DC 300mA power supply for XDR2

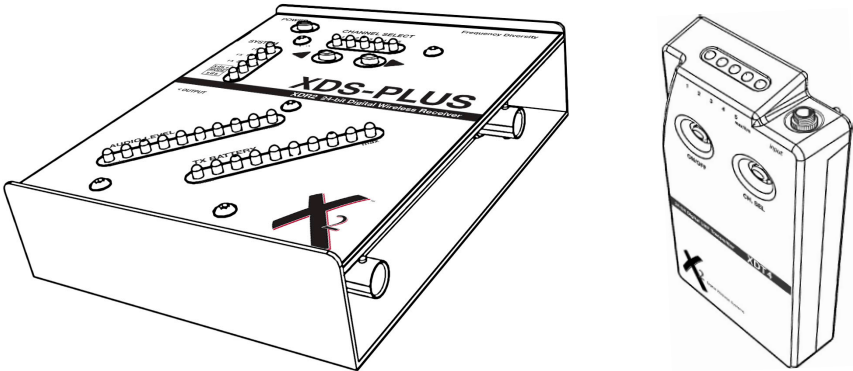

FIGURE 1

Receiver Controls & Front Panel

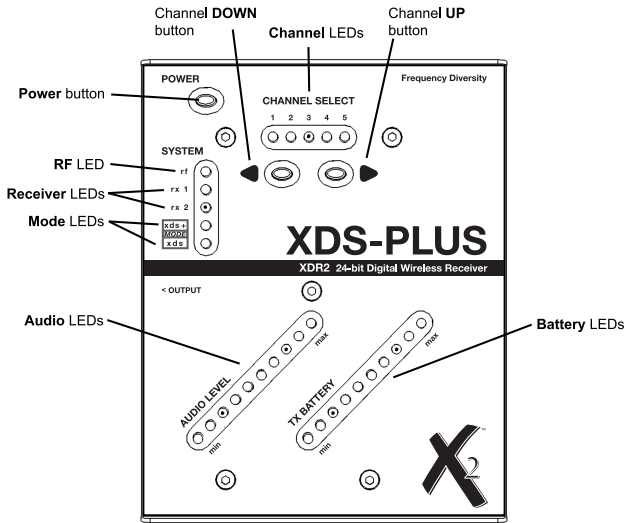

FIGURE 2

Power Button

Press once to turn the unit on. Press again to turn the unit off.

Channel Up & Down Buttons

Press the UP button to select the next channel. Press the DOWN button to select the previous channel. Button sequence does not wrap around. For example, once CH5 is selected you must press the DOWN button four times to reach CH1.

Channel LEDs

A blue LED will light indicating the currently selected channel of operation.

Audio LEDs

Blue LEDs will light indicating the audio signal level. There is no need for a CLIP indicator as the system has greater than 118 dB dynamic range and can accommodate input/output signals up to ~6V peak-to-peak.

Battery LEDs

Green LEDs will light indicating remaining battery life in the transmitter in 20 minute increments. The first three LEDs will glow red once the transmitter battery life falls below one hour. NOTE: Battery telemetry is only available with XDT4 transmitters.

RF LED

A red LED will light indicating that an RF signal is present on the currently selected channel.

Receiver LEDs

A green LED will light indicating that the unit is receiving data on one of two internal receivers. The unit houses two separate internal receivers. RX 1 represents the lower frequency while RX 2 represents the upper frequency. Please see Frequency Diversity description page at the end of this manual.

Mode LED

A green LED will light indicating XDS+ mode (factory) and ensures that your system is operating at full bandwidth and providing frequency diversity interference protection. A red LED will light indicating that the receiver is currently operating in XDS mode allowing operation with original XDT1 transmitters (non-frequency diversity).

NOTE: While in this mode, the frequency response will be (10 Hz - 12 kHz).

NOTE: Battery telemetry will be disabled when using XDT1 transmitters with XDR2.

Changing Receiver Operating Mode

To change the operating mode: power the unit off, press and hold the Channel DOWN button (left button) and power up. The unit will remain in the newly chosen and displayed mode until you repeat this process.

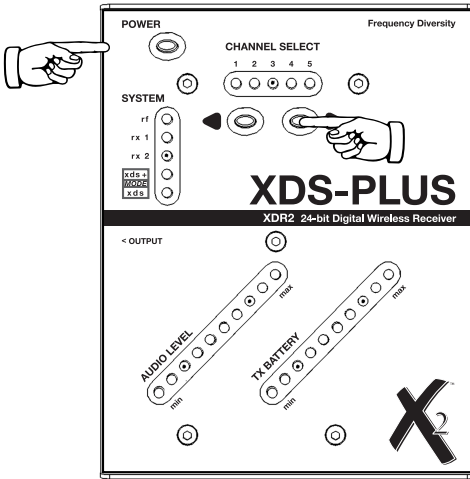

FIGURE 3

Receiver Connections

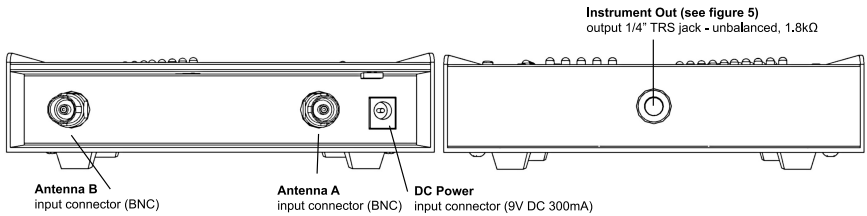

FIGURE 4

Antenna A & B Input Connector (BNC)

Diversity antenna inputs A and B. For correct operation connect the supplied detachable antenna by pressing on the BNC connector and twisting clockwise for ~1/2 turn. NOTE: Antenna inputs ARE NOT DC biased.

DC Power Input Jack

DC socket for connection of power supply, 9V DC 300 mA (supplied).



FIGURE 5

Instrument Output Jack

This 1/4" unbalanced TRS output jack (1.8 k Ω) is voiced at the tip for instrument applications (gentle high-frequency roll off at 8 kHz approximates sound of a 15' cable), and full bandwidth (10 Hz to 20 kHz) on the ring. Great for 'tuner' out or dual amp setups.

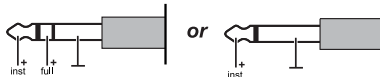

FIGURE 6

Antenna Installation

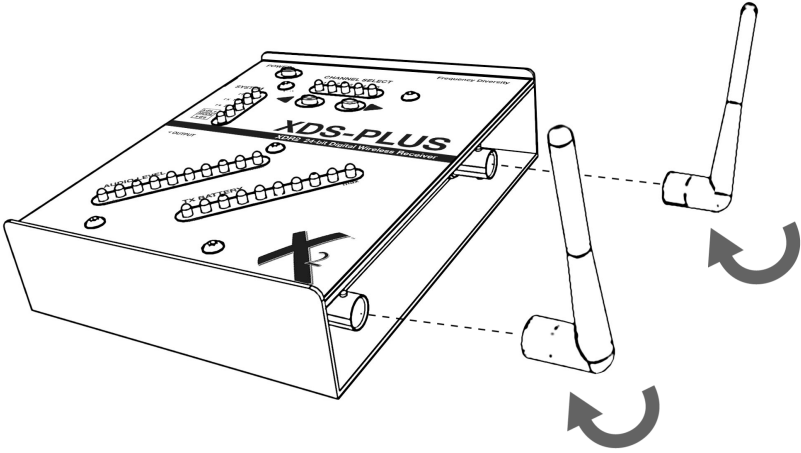

FIGURE 7

How to Connect the Supplied Antenna

Connect the supplied detachable antennas to the Antenna A and B inputs located on the back panel of the receiver and twist clockwise for ~1/2 turn as shown in figure 7.

NOTE: Antenna inputs ARE NOT DC biased

Transmitter Controls

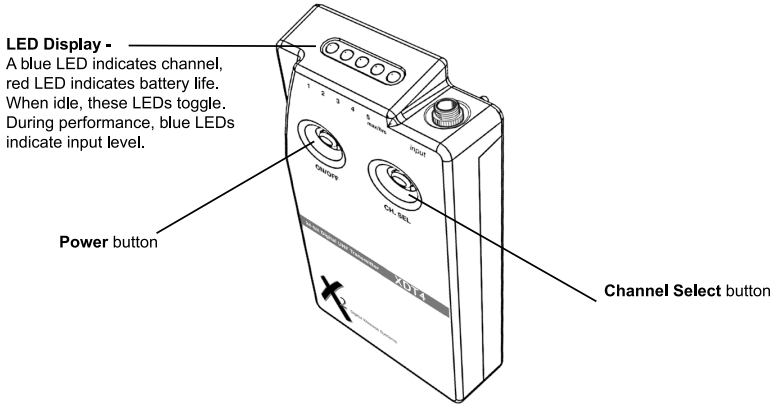

FIGURE 8

Power Button

Press once to turn the unit on. Press and hold to turn the unit off.

Channel Select Button

Press the CH SEL button to select the next channel. Button sequence will wrap around. For example, once CH5 is selected you must press the CH SEL button one time to reach CH1. Receiver must be set to the same channel as the corresponding transmitter in order to operate correctly.

LED Display

A blue LED will light indicating the currently selected channel of operation and a red LED indicates remaining battery life in one hour increments. When idle, these LEDs toggle continuously. During performance, blue LEDs indicate input level. There is no need for a CLIP indicator as the system has greater than 118 dB dynamic range and can accommodate input signals up to ~6V peak-to-peak.

Operating Modes for the Transmitter

The XDT4 ships in XDS+ mode from the factory and ensures that your system is operating at full bandwidth (10 - 20,000 Hz) while providing frequency diversity interference protection (you can be certain that the transmitter is operating in XDS+ mode if the audio level LEDs are lighting up in blue when signal is present). If required, the XDT4 can operate in standard XDS mode. This is necessary when using it with the original XDR1 receiver or other X2 receivers that are operating in standard XDS mode (you can confirm that the transmitter is operating in standard XDS mode if the audio level LEDs are lighting up in red when signal is present).

NOTE: While in standard XDS mode, the frequency response will be 10 - 12,000 Hz and frequency diversity (anti-jam) will be disabled.

NOTE: Battery telemetry will be disabled when using original XDT1 transmitters with XDR2.

Changing Transmitter Operating Mode

To change the operating mode: power the unit off, press and hold the Channel DOWN button (left button) and power up. The unit will remain in the newly chosen and displayed mode until you repeat this process.

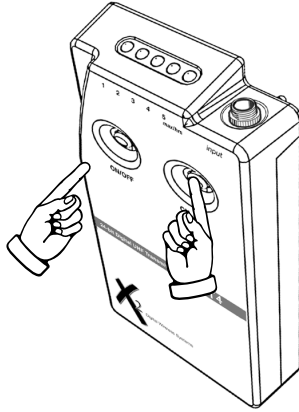

FIGURE 9

Transmitter Connectors

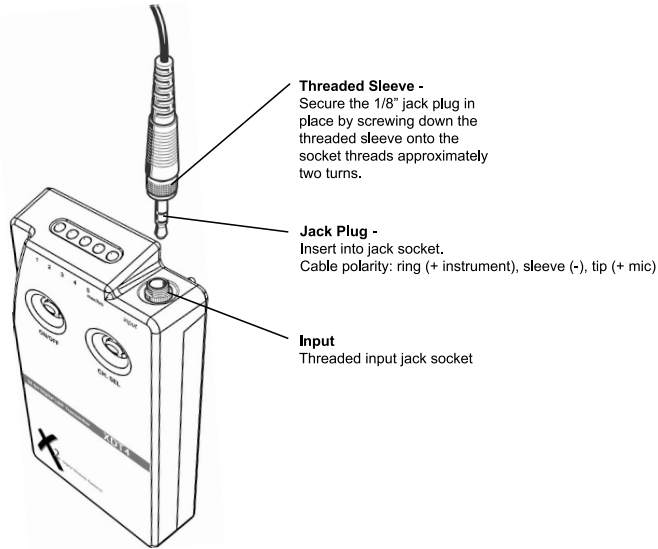

FIGURE 10

Threaded Sleeve

Secure the 1/8" TRS unbalanced jack plug in place by screwing down the threaded sleeve onto the input jack socket threads and turn approximately two times.

Jack Plug

For correct operation, the jack plug must be inserted all the way into the jack socket with the threaded sleeve securely fastened to the threaded input jack socket.

Threaded Input Jack Socket

Make certain that a secure connection is made for trouble-free operation.

Instrument Input

The instrument input circuit is wired to the ring of the input jack plug and socket.

NOTE: When using anything other than an X2 instrument cable, make certain to ground the tip when using this input (impedance is 1.3 M Ω).

Microphone Input

The microphone input circuit is wired to the tip of the input jack plug and socket.

NOTE: When using any other microphone not supplied by X2, make certain to ground the ring when using this input (impedance is 10K Ω).

NOTE: ~9V DC is supplied at the tip.

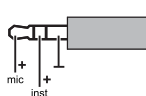

FIGURE 11

Preparing the Transmitter for Use

Battery Installation

Step 1:

Press and slide the battery door open and connect the 9V battery as shown in figure 12.

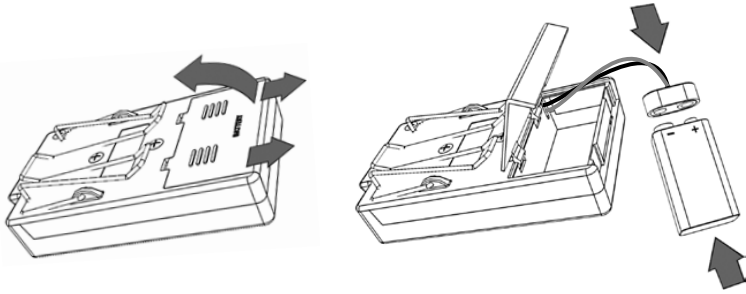

FIGURE 12

Step 2:

Insert the battery into the compartment and close the battery door then secure the door by sliding shut as shown in figure 13.

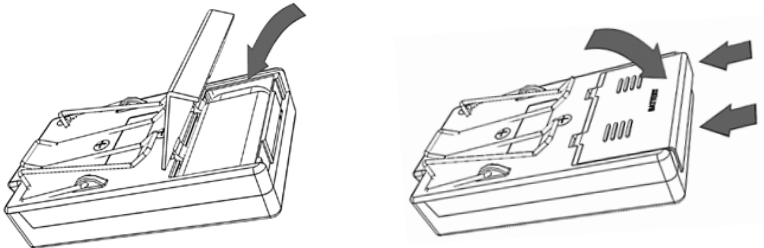

FIGURE 13

Battery Life

Fresh Alkaline batteries should last about ~5.5 hours in the XDT4. NiCad rechargeable batteries will only last about 3.5 hours. Standard batteries are not recommended. THE BATTERY HOUR DISPLAY WILL ONLY BE ACCURATE FOR ALKALINE BATTERIES. The battery life is calculated inside the each component and displayed in 1 hour increments. Upon power up the battery info will take about one minute to stabilize, the battery gauge is then accurate within + or - 15 min. You may use batteries until they are completely drained without affecting the performance of the unit in any way.

Transmitter Mounting Options

Attaching the Backpack to Clothing

The backpack transmitter is attached to clothing (e.g. guitar strap, belt, waistband) with the supplied belt clip as shown in figure 14.

The clip is detachable so that you can also attach the backpack transmitter with the input jack facing downwards. To do so, remove the clip and remount it reversing the orientation as shown in figure 15.

For thinner nylon-type guitar straps you can secure the transmitter by weaving the strap through the clip as shown in figure 16 or by running it straight up and down as in figure 17.

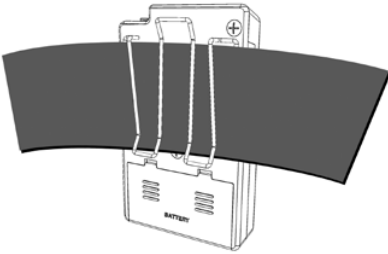

FIGURE 14

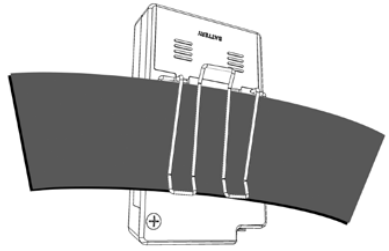

FIGURE 15

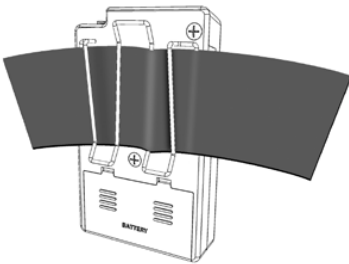

FIGURE 16

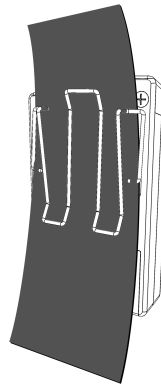

FIGURE 17

Troubleshooting

Issue	Cause	See Solution...
No sound.	System not turned on. Source malfunction. Improper connection or improper channel selection. Expired battery.	Power, Signal Source, Cables or RF
Intermittent sound or distorted sound.	Source malfunction. Improper connection. Multiple transmitters are set to the same operating channel. Transmitter has gone out of range. Transmitting through metal wall. Unknown source of RF in local area.	Signal Source, Cables or RF
Lack of range.	Improper or lack of antenna connection. Multiple transmitters are set to the same operating channel. Unknown source of RF in local area.	RF

Power

Make certain that the transmitter and receiver are receiving sufficient power. The receiver requires 9V DC at 300mA. The transmitter requires 9V DC via alkaline 9V battery. Check the battery status indicator on the transmitter and replace if necessary.

Signal Source

Make certain that the source is operating as desired by checking source power, signal levels and connections. If necessary, bypass digital wireless transmission and check the source directly.

Cables

Make certain that all connections and cables are in working order.

RF

Turn all known transmitters off. Check to see if the red RF LED on the receiver's front panel is lit. If it is not lit, then the receiver is not detecting the presence of RF signal on the currently selected channel. If it is lit, then the receiver is detecting the presence of unknown RF signal. Check to see if any of the green Receiver LEDs are lit. If any are lit, then the receiver is detecting the presence of another X2 transmitter set to the same channel. Locate this unit and either turn it off or switch channels. If none of the green Receiver LEDs are lit, then the receiver is detecting confirmed RF signal from a source other than an X2 transmitter. Change the channel and repeat these steps to locate a clear channel.

Optimizing Performance

RF Interference

An X2 Digital transmission is not susceptible to interference in the traditional 'analog' wireless sense. An X2 receiver will only pass digital data that originated from an X2 transmitter set to the same operating channel. If this transmitter has a custom encryption scheme, a standard X2 receiver will no longer be able to recognize or reproduce the signal. RF interference for X2 systems will only become noticeable when a system's range has been adversely affected or when the red RF indicator is lit without the desired transmitter in use. In most cases, the system will still operate reliably with a reduced performance range even when RF interference is present on your channel. Due to the anti-interference/anti-jamming technology available with the XDR-95 system, the chance of having a performance negatively impacted by RF interference is greatly reduced.

Increasing Range

Transmission range depends to a large extent on location and can vary the minimum and maximum performance range. There should be a "free line of sight" between transmitters and receiving antennas. For best results, maintain a line of sight between transmitter and receiver antennas. Move receiver antennas away from metal objects or other sources of RF interference (such as CD players, computers, digital effects, network switches, network cables, etc.). We recommend that you employ remote antennas when the receiver position is not the best antenna position for optimum reception. For multiple systems, make certain that each system is operating on it's own separate channel.

Multi-channel Operation

For multi-channel operation, it is recommended that you only use channels that are not in use by other performers. Before powering on additional transmitters, we recommend performing a quick RF scan. This is done at the receiver unit by selecting unused channels and checking for the presence of RF energy via the RF indicator on the front panel. If the channel is open, power on the desired transmitter and set it to the open channel. NOTE: When operating more than one system, maintain a minimum distance of 3 ft. from all other receiving antenna that are connected to systems other than your system.

Warranty Information

X2 Warranty Policy

X2 will repair or replace any defective system within the first two years free of charge. X2 will cover 2-day return shipping costs in the continental United States. This warranty is transferable, but does not cover abused systems. Terms and conditions subject to change without notice. Please retain a copy of your dated sales receipt for proof of warranty status should repairs become necessary.

Warning:

Changes or modifications not expressly approved in writing by X2 Corporation may void the users authority to operate this equipment.

This device complies with part 15 of the FCC rules. Operation is subject to the following two conditions: (1) This device may not cause harmful interference, and (2) this device must accept any interference received, including interference that may cause undesired operation.

RF Exposure Statement

This transmitter must not be co-located or operated in conjunction with any other antenna or transmitter.

NOTE: This equipment has been tested and found to comply with the limits for a Class B digital device, pursuant to part 15 of the FCC Rules. These limits are designed to provide reasonable protection against harmful interference in a residential installation. This equipment generates, uses and can radiate radio frequency energy and, if not installed and used in accordance with the instructions, may cause harmful interference to radio communications. However, there is no guarantee that interference will not occur in a particular installation. If this equipment does cause harmful interference to radio or television reception, which can be determined by turning the equipment off and on, the user is encouraged to try to correct the interference by one or more of the following measures:

- Reorient or relocate the receiving antenna.
- Increase the separation between the equipment and receiver.
- Connect the equipment to an outlet on a circuit different from that to which the receiver is connected.
- Consult the dealer or an experienced radio/ TV technician for help.

This Class B digital apparatus complies with Canadian ICES-003.

Cet appareil numérique de la classe B est conforme a la norme NMB-003 du Canada.

NOTE: This Radio equipment is intended for use in musical professional entertainment and similar applications.

SERVICE INFORMATION

Refer All Servicing to X2

We believe that this equipment is one of the most reliable wireless systems that can be made using current technology, and should provide years of trouble-free use. However, should problems occur, DO NOT attempt to service the unit yourself. Service on this product should only be performed by X2. THERE ARE NO USER SERVICEABLE PARTS INSIDE.

Obtaining Repair Service

Prior to contacting our service department, please take a moment to check over all of your connections, and make certain that you've read this owners manual. Your X2 dealer may also be able to provide you with additional support. If the problem persists, call X2 at (916) 779-1040 and request the customer service department. Talk your situation over with one of our technicians; if necessary, you will be given a return authorization (RA) number and instructions on how to return the unit. All units must be shipped prepaid. COD shipments will not be accepted. For prompt service, indicate the RA number on the shipping label. Tape a note on top of the unit describing the problem. Include your name and phone number where X2 can contact you if necessary. Also, please include instructions on where you would like the system to be returned. X2 will pay for 2nd-day shipping back to you on any repair covered under the terms of this warranty.

Service Address for customers in the USA:

X2 Digital Wireless Systems
4630 Beloit Drive, Suite 20
Sacramento, CA 95838
916-779-1040

Specifications

Overall System Specifications

Transmission Format:	X2 proprietary digital audio transmission
A/D -D/A Conversion:	24-bit Delta Sigma, 128 times over sampling
Frequency Response:	10 Hz - 20 kHz
Audio Dynamic Range:	>118 dB
Distortion:	0.03% THD
RF Carrier Frequency:	902 MHz to 928 MHz, FSK, dual frequency transmission
Selectable Frequencies:	Five
RF Output Power:	15mw
Audio Output Level:	Unity gain with transmitter input
Polarity:	Positive voltage at input yields positive voltage at output
Transmission Range:	~200 feet line-of-sight (may vary due to local conditions)
FCC Approval:	Part 15 approved, no user-license required
Operating Temp. Range:	-18° to +57° C (0° to +135° F)

XDR2 Receiver Specifications

Output:	2.12V RMS (Unbalanced: 1.8kΩ)
Connectors:	1/4" Unbalanced TRS output 1.8kΩ impedance, tip= instrument voicing, ring= full bandwidth, sleeve= ground
LED Display:	Power On, RF, Channel, Diversity, Battery Life, Audio Level Meter, Power On/Off, Channel UP and Down
Controls:	
Dimensions (HxWxD):	1.44 x 4.5 x 5.65 in. (3.66 x 11.43 x 14.35 cm)
Power Requirements:	9V DC 300mA via included AC/DC adapter
Weight:	12.8 oz
Housing:	Metal Chassis

XDT4 Transmitter Specifications

Input Impedance:	1.3 MΩ (ring) for Instrument, 10 KΩ (tip) for Mic
Connectors:	1/8" TRS locking connector, ring (+, instrument), sleeve (ground), tip (+, mic)
Controls:	Power On/Off, Channel Select
LED Display:	Five segment - Power On, Channel, Battery Life, Audio Level Meter
Dimensions (HxWxD):	2.4 x 4 x .8" (6.09 x 10.16 x 2.03 cm)
Battery Life:	Switching power supply, ~5.5 Hours (9V alkaline)
Weight:	4 oz (with 9V battery installed)
Housing:	Polycarbonate, impact tested to 300 lbs.

Frequency Diversity Technology Description

What is it?

A dual-frequency broadcast system that maximizes data isolation from undesired interference. RX 1 receives the lower RF broadcast while RX 2 receives the upper RF broadcast.

What does it do?

Allows the XDS-PLUS to provide reliable performance under adverse RF conditions.

Do other types of technology use dual-frequency broadcast?

Multiple frequency broadcasts are not unique. OFDM would be an example of splitting up data over multiple frequencies. However, X2's proprietary frequency diversity is unique for real-time audio applications.

Why do we need it?

Wireless systems are subject to increased interference due to known and unknown sources of RF interference, including DTV, cell phones, blackberrys and networking devices. XDR95 was designed to address the needs of professional wireless users requiring consistent reliable performance even in adverse conditions without any loss to sound quality.

How does it work?

In the transmitter, a proprietary digital data stream that includes a digital representation of the audio signal is split and modulated on two separate RF carrier frequencies. The receiver contains two separate receiver sections that work simultaneously to receive the two RF signals that contain the transmitted digital data.

Why is it better?

Frequency Diversity allows the XDS-PLUS to exceed other wireless systems in terms of freedom from negative audio side-effects of increased interference and longevity of performance in the field

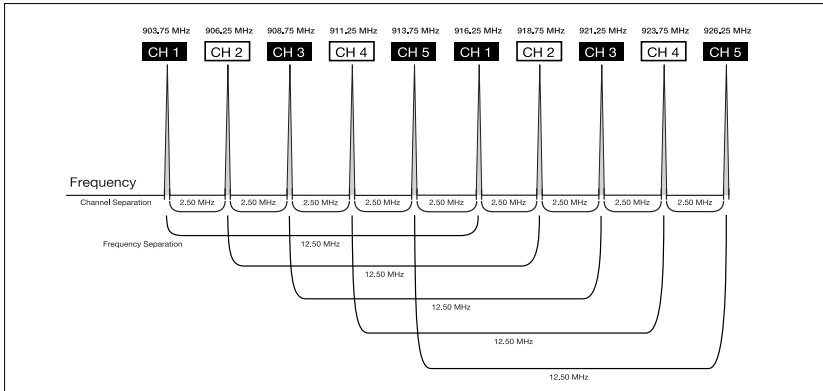

FIGURE 18